

1 Adapter 87151.051.00A for microwave sensor

The adapter is designed to mount the sensor for tests. Therefore the adapter is welded to a tube or vessel. A drill hole for the adapter of 60mm is needed.
The adapter is made of stainless steel 1.4404 (316L).

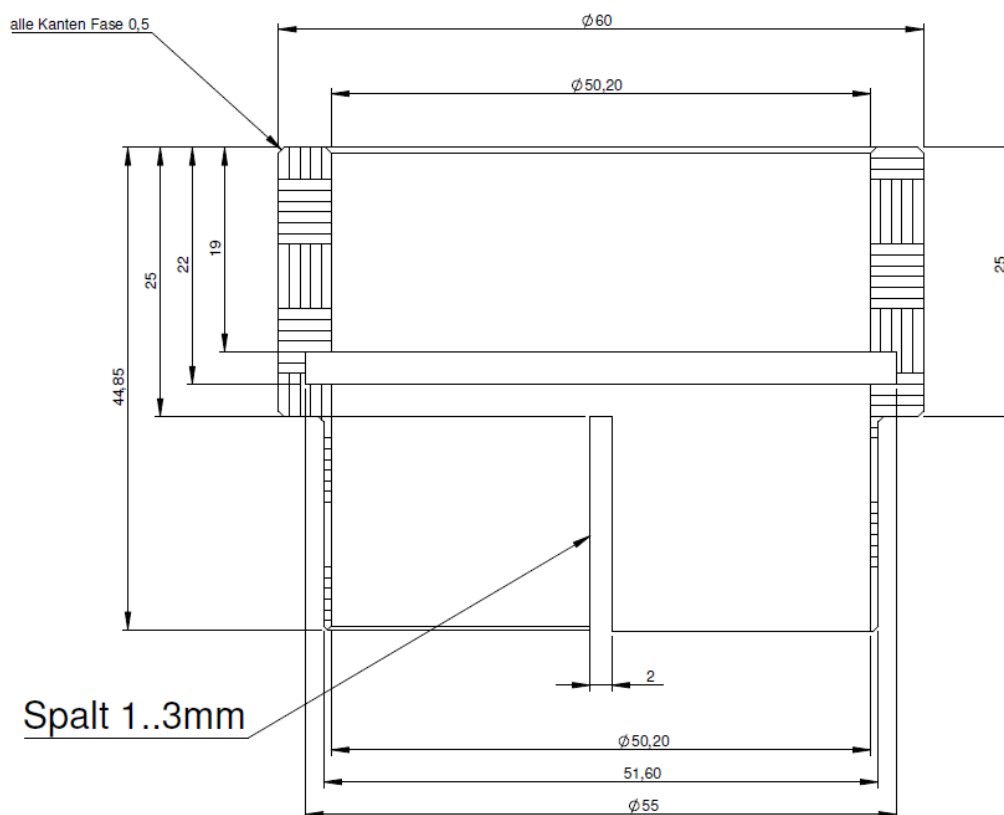

picture 1: adapter (slotted adapter, clamp, sealing ring)



picture 2: dimensions in mm

In the nut a sealing ring is mounted.

2 Adapter with microwave sensor

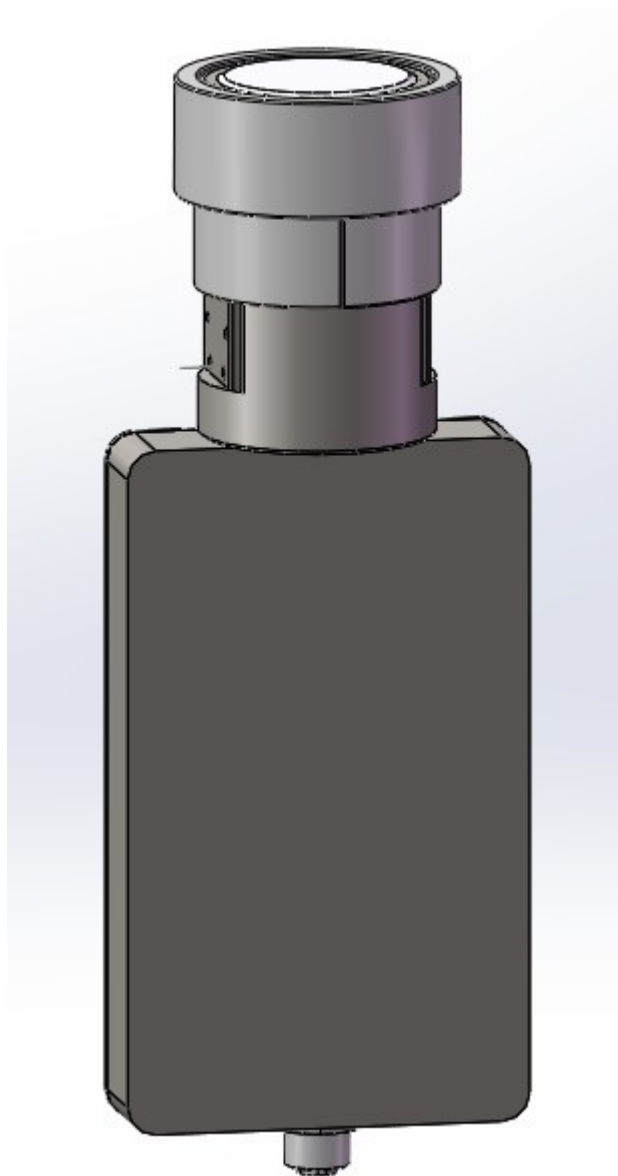

picture 3: Adapter with microwave sensor
(The clamp over the slotted part of the adapter is not shown.)

3 Company address

WORK Microwave GmbH
Rudolf Diesel Ring 2
D-83607 Holzkirchen
www.work-microwave.de